

### Modified rear hardtop locking element

Vehicle Type: **911 Carrera (996) / 911 Carrera 4 (996)**

Model Year: **As of 98 (W) – 05 (5)**

Equipment: Cabriolet

Concerns: **Modified rear hardtop locking element.**

Situation: **Noise complaints when driving with hardtop mounted.**

Note: On Cabriolet vehicles manufactured before the date of introduction listed below, noises can occur in the area of the C-pillar when driving with the hardtop mounted.

As of the date of introduction given, a modified hardtop locking mechanism has been installed in Cabriolet vehicles.

**Distinguishing** (modified/previous):

The catch (Figure 1, Item A) and insert of mounting console (Item B) are now threaded (arrow 1) on the modified locking mechanism.

Until now, the hardtop was locked using a bayonet catch (Figure 1, Item C) in the insert of the mounting console (Item D and arrow 2).



Bild...Figure...ill...figura...fig 1

**Note:**

The modified locking mechanism can be installed **retroactively** in the event of a repair or complaint. The locking mechanism must be replaced on the left and right (Procedure → Page 2).

It is not permissible to use the previous and the modified locking mechanism (**mixed configuration**) simultaneously.

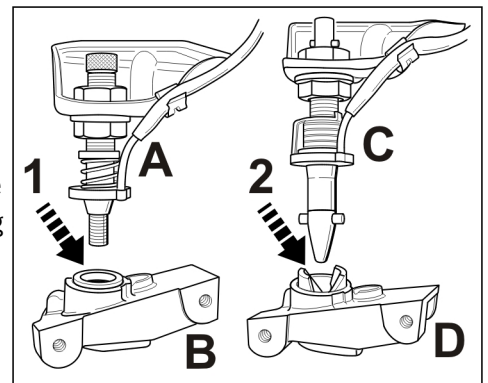
Due to the modified operation of the hardtop locking element, a supplement to the Driver's Manual must be given to the customer after the vehicle is converted.

Introduction: August 31, 2004, as of Vehicle Ident. Nos.:

99 Z5S 64 0143 911 Carrera/RoW

99 25S 65 0211 911 Carrera/USA

Part Nos.: **000.043.300.46** New/modification kit for hardtop locking element

The modification kit contains the following parts:

996.563.413.01	Tool for hardtop locking element (with black handle)
996.563.403.04	Left catch (screw catch)
996.563.404.04	Right catch (screw catch)
900.378.030.09	M6 x 20 screw for catch (6 ea. contained in set)
996.561.653.04	Left mounting (for screw catch)
996.561.654.04	Right mounting (for screw catch)
900.378.173.09	M6 x 20 screw to fasten the mounting (8 ea.)
WKD 996.719.05	Supplement to Driver's Manual

- Procedure:
- 1 Remove hardtop, → POSES, Workshop Manual 911 Cabriolet, Group 6, 61 02 19 – Removing and installing hardtop.
  - 2 Replace hardtop locking element, → POSES, Workshop Manual 911 Cabriolet, Group 6, 61 11 19 – Removing and installing hardtop locking element.

- 3 Replace mounting console on left and right.
  - 3.1 Remove cover over the roll-over bar, → POSES, Workshop Manual 911 Cabriolet, Group 6, 69 72 19 – Removing and installing roll-over bar.



Bild...Figure...ill...figura...fig 2

- 3.2 Remove left and right mounting console. The mounting consoles (Figure 2, arrow 1R/1L) are fastened with four M6 x 20 hexagon-head bolts each (Item 2). Disconnect the electric plug connection on the left mounting, → POSES, Workshop Manual 911 Cabriolet, Group 6, 61 42 19 – Removing and installing rear side section flap.
- 3.3 Install modified mounting console on the **left** (996.561.653.04) and **right** (996.561.654.04). Insert mounting console on the left/right on the vehicle and screw down with four M6 x 20 hexagon-head bolts each (Figure 2, Item 2). **Tightening torque: 10 Nm (7.5 ftlb.)**. Join the electric plug connection on the left mounting, → POSES, Workshop Manual 911 Carrera Cabriolet, Group 6, 61 42 19 – Removing and installing rear side section flap.
- 4 Install cover over the roll-over bar, → POSES, Workshop Manual 911 Carrera Cabriolet, Group 6, 69 72 19 – Removing and installing roll-over bar.
- 5 Adjust hardtop, → POSES, Workshop Manual 911 Carrera Cabriolet, Group 6, 61 02 15 – Adjusting the hardtop.

- Procedure:
- 6 Lock hardtop.
  - 7 Due to the conversion of the locking mechanism, the operation of the rear hardtop locking element has changed. Therefore, invalidate the corresponding pages in the Driver's Manual of the vehicle which was converted to the new hardtop locking element by making a diagonal cross through them.

**Note:**

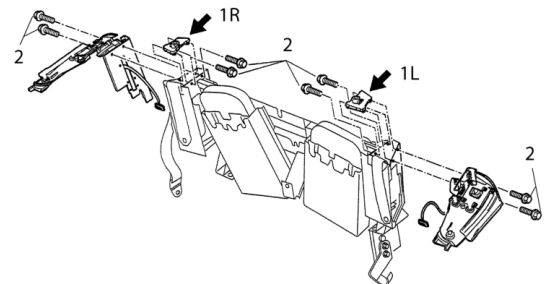
Please inform the customer about the modified operation of the hardtop locking element when handing over the vehicle and give him the supplement for the vehicle Driver's Manual contained in the modification kit in the respective country's language.

- References: POSES, Workshop Manual 911 Carrera Cabriolet (996):
- > Group 6:
    - 61 02 19 – Removing and installing hardtop.
    - 61 02 15 – Adjusting the hardtop.
    - 61 11 19 – Removing and installing rear hardtop locking element.
    - 61 42 19 – Removing and installing rear side section flap.
    - 69 72 19 – Removing and installing roll-over bar.